

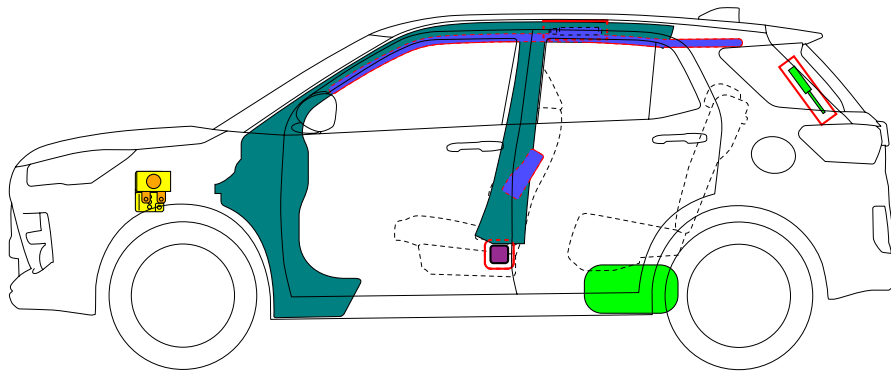

TOYOTA RAIZE

2021-6

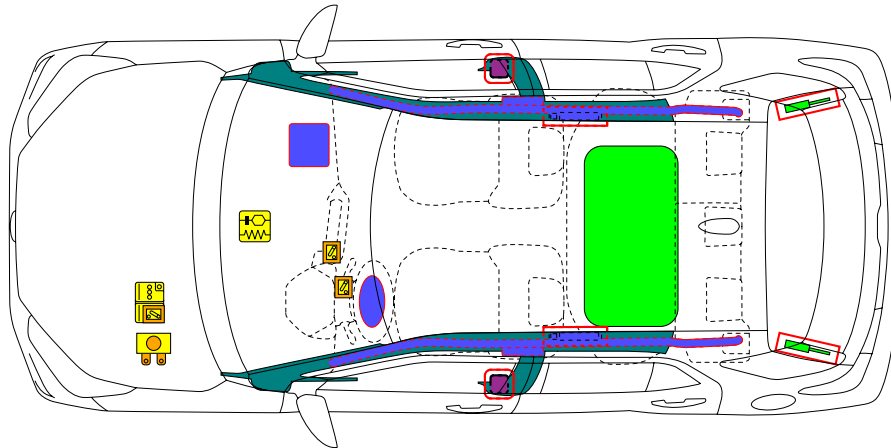

	Airbag		Stored gas inflator		Seat belt pretensioner		SRS control unit		Pedestrian protection active system
	Automatic rollover protection system		Gas strut / Preloaded spring		High strength zone		Zone requiring special attention		
	Battery low voltage		Ultra capacitor, low voltage		Fuel tank		Gas tank		Safety valve
	High voltage battery pack		High voltage power cable / component		High voltage disconnect		Fuse box disabling high voltage system		Ultra capacitor, high voltage
	Low voltage device that disconnects high voltage								
	ID No.	Version No.		Version date		Page			
	RAIZE250	01		06 / 2021		1 / 4			

1. Identification / Recognition



Lack of engine noise does not mean vehicle is off. Silent movement or instant restart capability exists until vehicle is fully shut down.

Location of vehicle badges

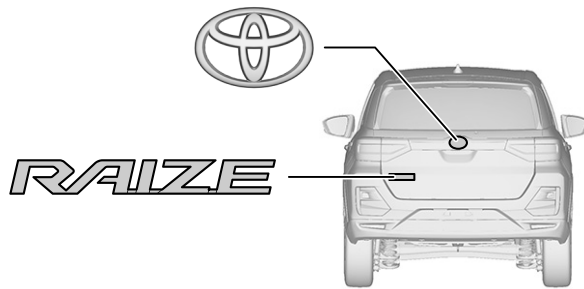

2. Immobilisation / Stabilisation / Lifting

Completely immobilize the vehicle

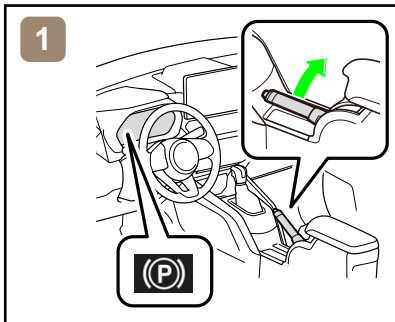

1. Chock the wheels and engage the parking brake.

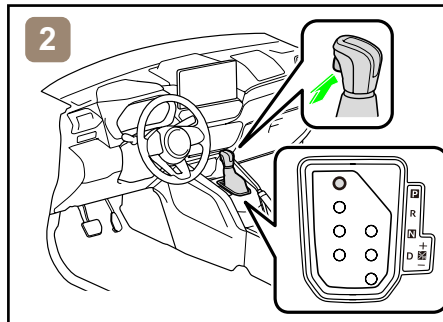

2. Move the shift lever to the park (P) position.*1

*1: CVT

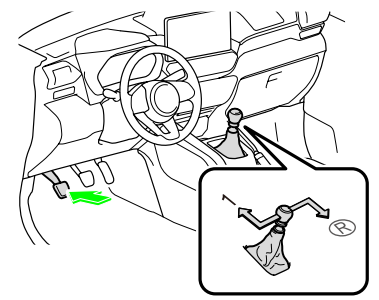

2. Depress the clutch pedal and move the shift lever to the 1st or reverse (R) position.*2

*2: M/T

Stabilisation-lifting point

Place cribbing such as wooden blocks at the four points under the front and rear pillars.

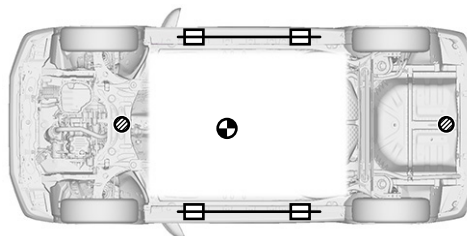

Extra Reinforced Lifting Points



Standard Jack Locations



Vehicle Center of Gravity



Do not place cribbing such as wooden blocks or rescue air lifting bags under the exhaust system or fuel system. Doing so may result in fuel leaks or fire.

3. Disable direct hazards / Safety regulations

If any of the following systems are required to be operated, operate them **BEFORE** disconnecting the battery.

Power door lock

Power window

Back door opener



When the 12 V battery is disconnected, electrical components cannot be operated.

	ID No.	Version No.	Version date	Page
	RAIIZE250	01	06 / 2021	2 / 4

■ Perform procedure Main or Alternative to completely shut off the vehicle.

<Procedure Main>

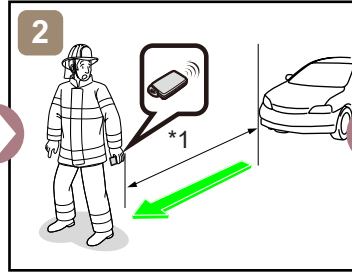
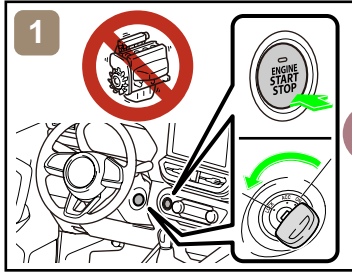
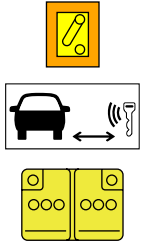

*1: 5 m (16.4 ft) or more

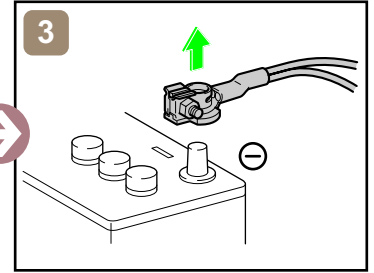

<Procedure Alternative>

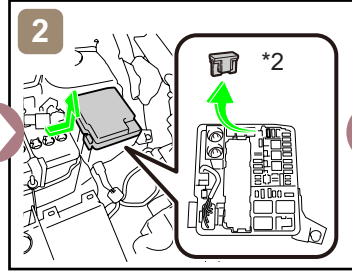
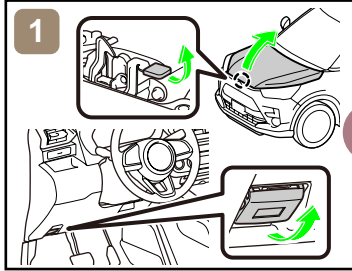
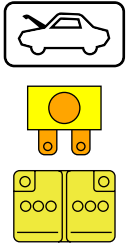

*2: EFI FUSE (15 A BLUE)

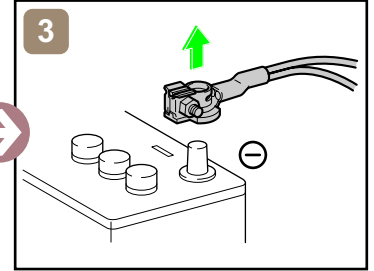

■ Access to 12 V Battery

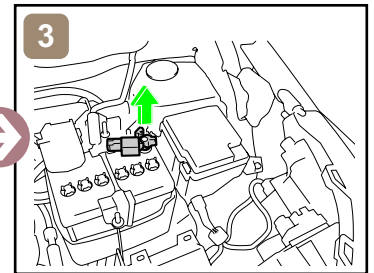
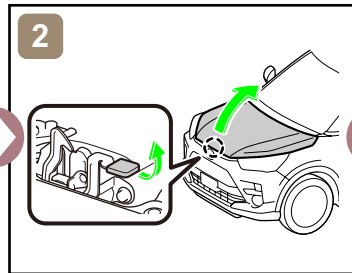
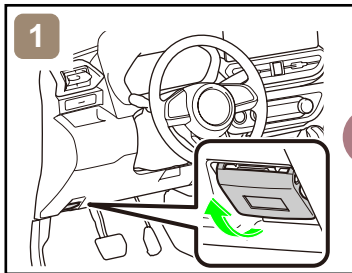
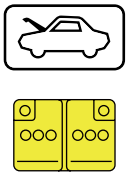

4. Access to the occupants

■ Window Glass

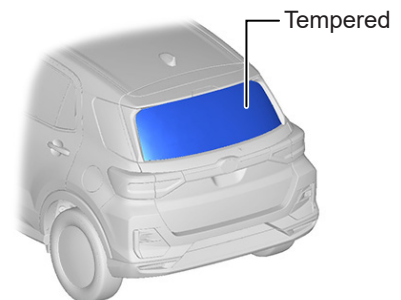
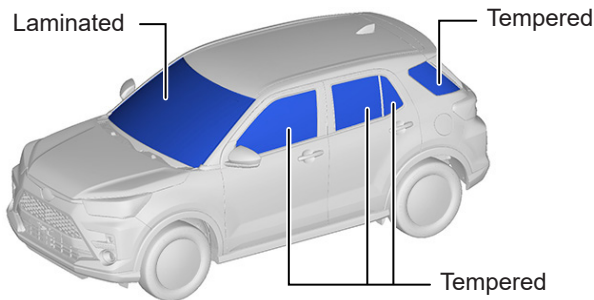

ID No.	Version No.	Version date	Page
RAIZE250	01	06 / 2021	3 / 4

5. Stored energy / Liquids / Gases / Solids



12 V Battery



Gasoline Tank: 36L

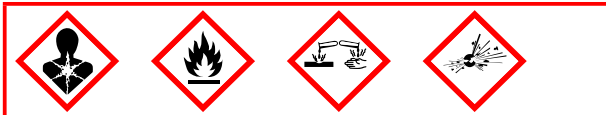

Always wear appropriate personal protective equipment (PPE) when dealing with any of these items.

6. In case of fire



RE-IGNITION POSSIBLE !

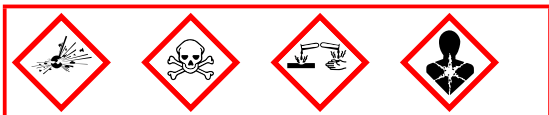

7. In case of submersion



Work on the vehicle only after the vehicle has been pulled out of the water.

8. Towing / Transportation / Storage

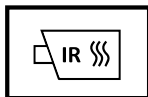
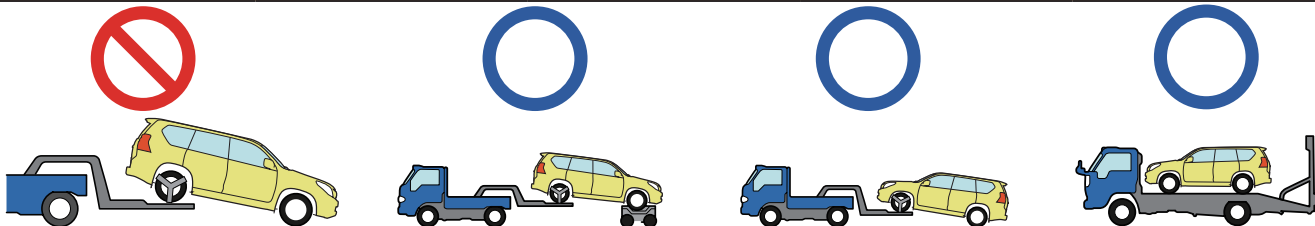

RE-IGNITION POSSIBLE !

Store the vehicle at a safe distance (15 m (49.2 ft) or more) from other vehicles.

9. Important additional information

For further details, please refer to "Emergency Response Guide".
<http://www.toyota.co.jp/#####/>

	ID No.	Version No.	Version date	Page
	RAIZE250	01	06 / 2021	4 / 4